

**Wireless Telemetry Miniature Connectivity Module
with optional Battery Pack (T24-BB1)**

Features



- Miniature connectivity enclosure (20 x 35 x 60mm)
- For strain, current or voltage input
- Separate (optional) battery pack - 2 x AAA cells
- IP54 Rated
- Internal chip antenna giving up to 100m range
- Simple configuration and calibration of acquisition module via PC using base station & T24 Toolkit Software
- 1 Year manufacturer’s warranty



T24-ACMm Connected to optional Battery Pack T24-BB1:



Introduction

The T24-ACMm enclosure is designed for Mantracourt’s range of telemetry acquisition modules: T24-SA (Strain Acquisition), T24-IA (0-20mA Current Acquisition), T24-VA (0-10V Voltage Acquisition).

The optional T24-BB1 provides battery power using 2 x AAA Cells and is connected to the ACMm via simple 2 part screw field terminals for easy wiring.

The enclosure has simple 2 part screw field terminals for easy wiring to a variety of sensors. Users also have the option to fit wired completion resistors allowing a strain input to be either full, half or quarter bridge input.

Specifications

Electrical	Min	Typical	Max	Units
Battery Supply voltage	2.1	3.0	3.6	Vdc

Environmental				
IP rating		IP54		
Operating temperature range *	-40		+65	C
Storage temperature	-40		+85	C
Humidity	0		95	%RH

General Radio

	Min	Typical	Max	Units
Licence		Licence Exempt		
Modulation method		MS (QPSK)		
Radio type		Transceiver (2 way)		
Data rate		250		K bits/sec
Radio Frequency	2.4000		2.4835	GHz
Power		1		mw
Range RAD24i (Integrated antenna)			100 (325)	Metres (feet) **
Channels (DSSS)		16		

*Check operating temperature of AAA cells intended for use.

** Maximum range achieved in open field site with T24-SA at a height of 3 metres above ground and T24-HS held at chest height pointing towards the T24-SA.

Product Order Codes

T24-ACMm	Wireless Radio Telemetry Acquisition Enclosure	T24-HR	Wireless Radio Telemetry Handheld Display Unlimited Inputs
T24-BB1	Battery Enclosure	T24-HS	Wireless Radio Telemetry Handheld Display Single Inputs
T24-ANTA	Wireless Radio Telemetry Antenna	T24-IA	Wireless Radio Telemetry Current (4-20mA) Acquisition Module
T24-ANTB	Wireless Radio Telemetry Antenna	T24-PR1	Wireless Radio Telemetry Printer
T24-ANTC	Wireless Radio Telemetry Antenna	T24-RM1	Wireless Radio Telemetry Data to Relay output
T24-AO1	Wireless Radio Telemetry Desktop Analogue Output Module	T24-SA	Wireless Radio Telemetry Strain Gauge /Load Cell Acquisition Module
T24-AO1i	Wireless Radio Telemetry Industrial Analogue Output Module	T24-Saf	Module
T24-BC1	Battery Charger for T24 Acquisition Modules	T24-SO	Wireless Radio Telemetry 2KHz Strain Gauge Acquisition Module
T24-BSi	Wireless Radio Telemetry Industrial Base Station	T24-TK	Wireless Radio Telemetry Printer and Display Driver
T24-BSu	Wireless Radio Telemetry Base Station USB	T24-VA	Wireless Radio Telemetry Toolkit Software
T24-DPV	Wireless Radio Telemetry T24 Data Provider Viewer and Logger		Wireless Radio Telemetry Voltage (0-10V) Acquisition Module
T24-HA	Wireless Radio Telemetry Handheld Display Multiple Inputs		

Mechanical Details

T24-ACMm & T24-BB1 Enclosure Dimension

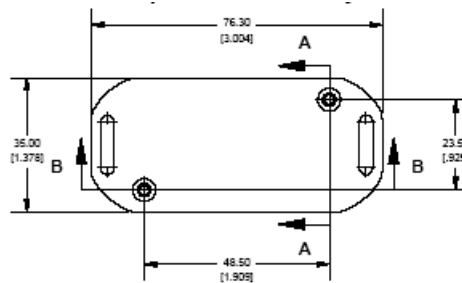

Case dimensions 20 x 35 x 76mm Case materials Black ABS IP54. Flanged lid for wall or shelf mounting or suspending with a tie wrap

Lid Depth inc lid 2mm (0.079")
Width 35mm (1.38")
Length not inc flange 76mm (2.99")

Approvals

CE, Complies with EMC directive. 2004/108/EC
The Radio Equipment and Telecommunications Terminal Equipment (R&TTE) Directive, 1999/5/EC.



Industry Canada Industrie Canada



Designed, Manufactured & Supported in the UK

In the interests of continued product development, Mantracourt Electronics Limited reserves the right to alter product specifications without prior notice.