

Digital Strain RS485 Display Module

Features

- Displays up to 8 DSC or DLC individual or summed devices
- Removes the need for DSC/DLC to be permanently connected to a PC or PLC
- Synchronised sampling across devices
- Gross/Net Toggle
- Easy to operate toggle buttons
- 6 Digit 20mm LED Display in Red
- Sealed to IP65
- 3 year Warranty
- Bulkhead mounted



Introduction

The DS485DIS is an LED display module allowing the connection and summing of up to eight (8) DSC or DLC devices. The display enables the use of DSC or Dcells without the need for permanent connection to a PC or PLC.

The display can toggle between gross and zeroed net display and optionally allows the user to cycle through the individual displays that form the sum. The inputs are all synchronised so the summed display is a true representation of the instantaneous input without skew.

Requirements

This display can connect to various RS485 DSC and DLC devices with the MantraBus II protocol. Suitable devices are: DSC4SMAN, DSC4HMAN, DLCSMAN and DLCHMAN.

The DSC and DLC devices must have sequential station numbers from 1 to the total number of devices. The default baudrate is 115200.

Configuration

This module is configured using an RS232 connection to a PC or laptop. Mantracourt's Instrument Explorer with a DS485DIS driver is used for configuration. The station number of this module is fixed at 253 and the default RS232 & RS485 baudrates are 115200

Specifications

| | |
|--|--|
| Supply Voltage | Nominal 8 to 18V |
| Current Consumption (no modules connected) | Nominal 200mA max |
| Communications Module Communications Bus | RS485 8 data bits, 1 stop bit, no parity |
| Configuration Bus | RS232 8 data bits, 1 stop bit, no parity |

Connecting to up to 8 DSCs using DSJ4



Product Order Codes

DS485DIS Digital Strain RS485 Display Module

Support Modules

| | |
|----------|---|
| DSC4SMAN | DSC Digital Strain Card Industrial Stability RS485 for MANTRABUS protocol |
| DSC4HMAN | DSC Digital Strain Card High Stability RS485 for MANTRABUS protocol |
| DLCSMAN | Dcell Digitiser Industrial Stability for RS485 MANTRABUS protocol |
| DLCHMAN | Dcell Digitiser High Stability for RS485 MANTRABUS protocol |

Physical

| | |
|-----------------|--|
| Case dimensions | 160 x 80 x 55mm |
| Case materials | Light grey ABS with IP65 cable glands |
| Terminals | 2.5mm, saddle field terminals |
| Accessibility | All electronics accessible by removing lid |

Mechanical Dimensions

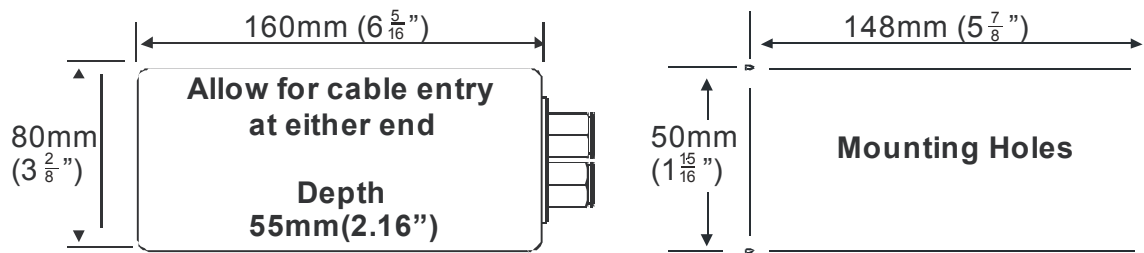

CE & Environmental

| | | | |
|-----------------------|----------------------------|------------------------|-------------|
| Storage temperature | - 20 to +70°C | European EMC Directive | 2004/108/EC |
| Operating temperature | -10 to 50°C | Low Voltage Directive | 2006/95/EC |
| Relative humidity | 95% maximum non condensing | | |



Designed, Manufactured
& Supported in the UK



CE In the interests of continued product development, Mantracourt Electronics Limited reserves the right to alter product specifications without prior notice